

GREAT BARRIER ISLAND

TOURIST INFORMATION

From December 1986

Another

Great Barrier Airlines Service





Great Barrier Airlines Ltd.

Daily Service and Island Safaris



Dear Travel Agent,

Enclosed is a dossier, compliments of Great Barrier Airlines Limited, of Tourist accommodation, rental car, taxi and activities on the Great Barrier Island.

G.B.A. commenced operation on December 2, 1983 and provide an all year round scheduled airline service for the Barrier. A minimum of two schedules are operated daily between Auckland and the Island increasing to flights every two hours during peak and holiday periods. A minimum twice weekly service is also operated between Tauranga-Pauanui and the Barrier.

Commencing in December 1986 we will be operating a Waiheke Island Air Ferry service with a minimum of four services daily between Auckland and Waiheke Island. Some Barrier Island flights are scheduled through Waiheke Island, Great Barrier Island connection. G.B.A's Auckland terminal is Auckland Airport at Mangere where we have counter facilities in the Domestic terminal. Barrier services are operated in and out of the Islands, two airfields, Claris, the main airport and Okiwi in the north. On the mainland a pick-up, drop-off stop is flown through Ardmore airfield, the general aviation field in South Auckland. Preference is for passengers to depart and arrive at Auckland Airfield.

On the Barrier Island G.B.A. provides FREE "AIRPORTER" mini bus transfer to/from both Airfields to all lodges, motels and Guest houses as well as to the main settlement areas of Tryphena, Whangaparapara and Port FitzRoy. G.B.A's service is a complete Air and ground package and we have 24 seats available on each service flight.

G.B.A. is owned and operated by Professional Airline Pilots. The Managing Director is an ex Jumbo jet 747 pilot, a director currently flying for the company is jet rated and the other two directors are present Jumbo Jet 747 pilots flying Air New Zealand's International Air Routes. With this Professional management G.B.A. air service is second to none for safety, reliability and consideration to its passengers.

The Great Barrier Island is a new discovery destination. The Island is very primitive, there is no electric power supply, individual diesel generators are used, the roads are one way clay and metal tracks and the manual phone system dates back to the 1930's. There are magnificent beaches particularly on the Island's East Coast and very good forestry walks with well equipped huts for accommodation. The Lodges and Guest houses are of varying standards but all are clean and provide excellent meals. There are three tour operators; Safari Tours in Tryphena, Scenic Tours in Claris and Aotea Tours at Port FitzRoy. At present two commercial boat operators are offering boat and dive trips, day or overnight. Aotea Tours, Tryphena and Great Barrier Charters in Port FitzRoy. As you will see in the brochure rental cars and motor cycles as well as taxi services are available. There is no public transport at present on the Island except for G.B.A's Airporter transfer buses, however a public bus service may soon be commenced.

In the main the Island is warmer than the mainland, particularly on the East Coast. There are no hotels on the Island, however a Club is situated in Tryphena which has full bar facilities and an evening meal service. Most Lodges accept casual guests for meals and wine etc. is usually available. A wine shop is situated at Mulberry Grove, Tryphena Harbour and there are four Island shops.

I trust this and the following information will assist you with your bookings for the Barrier.

G.B.A. accepts all travel agents' vouchers for airfares less 5% commission and complete tour packages are available in conjunction with the N.Z. Adventure Centre in Victoria Park Market, Auckland. Phone 399-192 or 399-194. A/H 489-817. P.O. Box 72068, Auckland 9 or Telex KZ63091.

G.B.A. provides a 24 hour booking service and booking may be made by phoning collect. We prefer bookings to be made during normal office hours wherever possible.

G.B.A. Phone 275-6612 or 275-9120

A/Hours (City Office) 779-384 24 hours

P O Box 53073, Auckland Airport or telex.

Yours faithfully,
GREAT BARRIER AIRLINES

Gerard Rea
Director



Great Barrier Airlines Ltd

THE BARRIER ISLAND CONNECTION



Daily return
Air services between
Auckland (Mangere),
Claris and Okiwi,
Great Barrier Island
Tauranga
Waiheke Island
Pauanui

Telephone 275-6612
275-9120 A/H 779-384

SUMMER TIMETABLE 86/87

FROM AUCKLAND (Mangere) to WAIHEKE ISLAND

Day	Departs	Arrives	Flt. No.
Daily	7.30 am	7.40 am	W11
Daily	11.00 am	11.10 am	W13
Daily	1.00 pm	1.10 pm	W15
Daily	5.00 pm	5.10 pm	W17

FROM WAIHEKE ISLAND to AUCKLAND

Day	Departs	Arrives	Flt. No.
Daily	7.45 am	7.55 am	W12
Daily	11.15 am	11.25 am	W14
Daily	1.15 pm	1.25 pm	W16
Daily	5.15 pm	5.25 pm	W18

Special Charters Available To/From Ardmore Airfield.

NOTE: WAIHEKE ISLAND FLIGHTS
SUBJECT TO TOWN PLANNING
APPROVAL OF USE OF AIRFIELD

SCHEDULED AIRSERVICES

BETWEEN

Auckland (Mangere and Ardmore), Tauranga, Pauanui,
Waiheke Island and the Great Barrier Island

SUMMER TIME TABLE

Commencing 10 Dec. 86

FROM AUCKLAND (Mangere and Ardmore) to GREAT BARRIER ISLAND

Day	Departs	Arrives	Flt. No.
Daily	8.30 am	9.10 am	GB1
Mon. Wed. & Fri.	11.00 am	11.40 am	GB3
Daily	3.00 pm	3.40 pm	GB7
Fri. Sun.	5.00 pm	5.40 pm	GB9

FROM GREAT BARRIER ISLAND (Claris and Okiwi) to AUCKLAND

Day	Departs	Arrives	Flt. No.
Daily	9.30 am	10.10 am	GB2
Mon. Wed. & Fri.	2.00 pm	2.40 pm	GB6
Daily	4.00 pm	4.40 pm	GB8
Fri. Sun.	6.00 pm	6.40 pm	GB10

FROM GREAT BARRIER ISLAND (Claris and Okiwi) to TAURANGA and PAUANUI

Day	Departs	Arrives	Flt. No.
Wed. Sun.	12 midday	1 pm	GB201

Arrives Pauanui 12.25 p.m.

FROM TAURANGA and PAUANUI to GREAT BARRIER ISLAND

Day	Departs	Arrives	Flt. No.
Wed. Sun.	2 pm	3.00 pm	GB202

Departs Pauanui 2.30 p.m.

FROM WAIHEKE ISLAND to GREAT BARRIER ISLAND

Day	Departs	Arrives	Flt. No.
Mon. Wed. & Fri.	11.10 am	11.40 am	GB3
Sat.	8.40 am	9.10 am	GB1

FROM GREAT BARRIER ISLAND (Claris and Okiwi) to WAIHEKE ISLAND

Day	Departs	Arrives	Flt. No.
Mon. Wed. & Fri.	2.00 pm	2.30 pm	GB6
Sun.	4.00 pm	4.30 pm	GB8

THE GREAT BARRIER



Great Barrier
Airlines Ltd

Phone Auckland 275-6612. 275-9120
A/Hrs 779-384 24 hours

THE BARRIER ISLAND CONNECTION

INVITES YOU TO

Auckland's own Pacific island where time a magic spell,
the air is pure and the waters clean and clear . . .

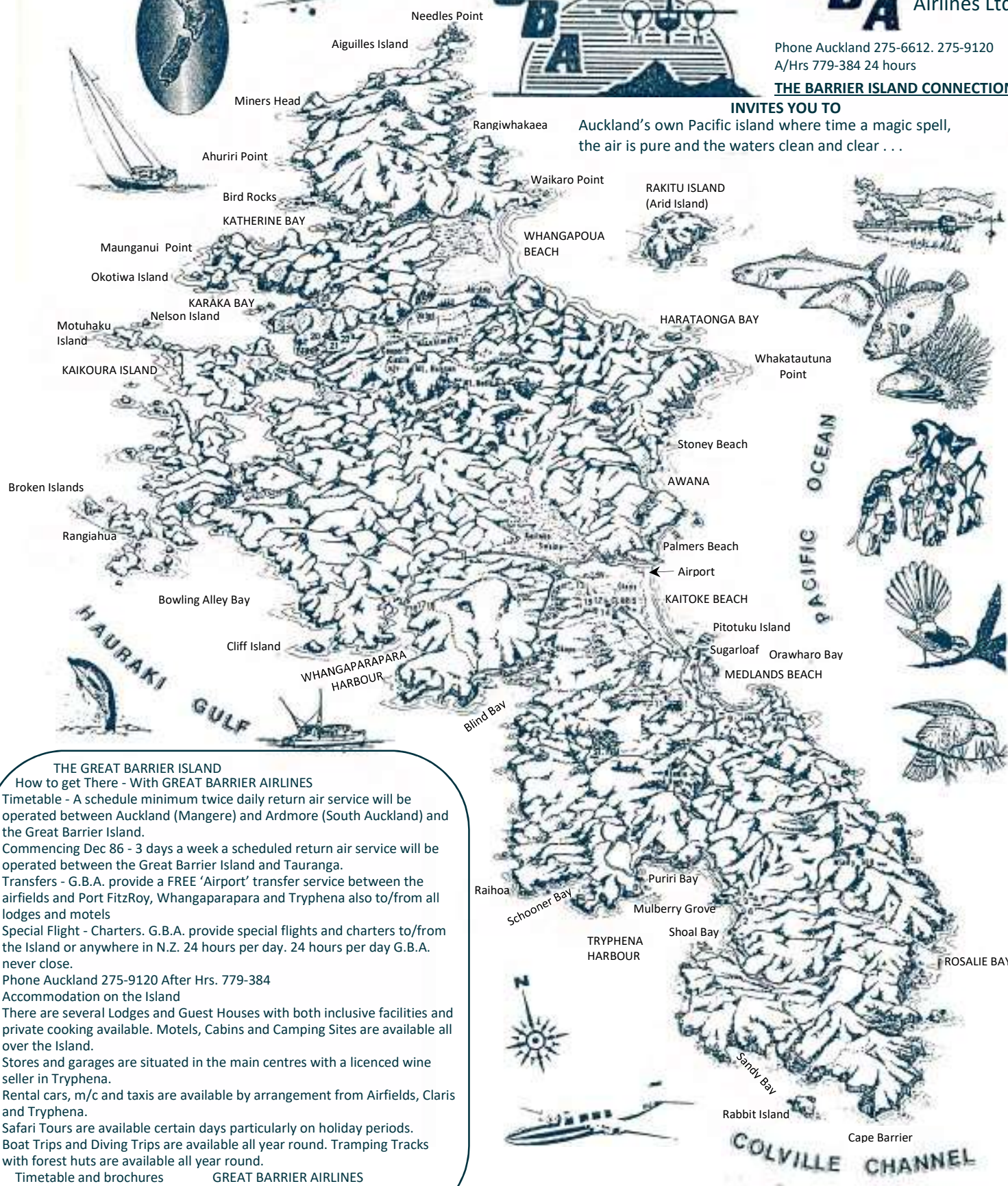

THE GREAT BARRIER ISLAND

How to get There - With GREAT BARRIER AIRLINES

Timetable - A schedule minimum twice daily return air service will be operated between Auckland (Mangere) and Ardmore (South Auckland) and the Great Barrier Island.

Commencing Dec 86 - 3 days a week a scheduled return air service will be operated between the Great Barrier Island and Tauranga.

Transfers - G.B.A. provide a FREE 'Airport' transfer service between the airfields and Port FitzRoy, Whangaparapara and Tryphena also to/from all lodges and motels

Special Flight - Charters. G.B.A. provide special flights and charters to/from the Island or anywhere in N.Z. 24 hours per day. 24 hours per day G.B.A. never close.

Phone Auckland 275-9120 After Hrs. 779-384

Accommodation on the Island

There are several Lodges and Guest Houses with both inclusive facilities and private cooking available. Motels, Cabins and Camping Sites are available all over the Island.

Stores and garages are situated in the main centres with a licenced wine seller in Tryphena.

Rental cars, m/c and taxis are available by arrangement from Airfields, Claris and Tryphena.

Safari Tours are available certain days particularly on holiday periods.

Boat Trips and Diving Trips are available all year round. Tramping Tracks with forest huts are available all year round.

Timetable and brochures

GREAT BARRIER AIRLINES

are available contact

P.O. Box 53073, Auckland Airport

Phone 275-9120 After hrs. 779-384

Marine Fuel available at Whangaparapara.
Call Great Barrier Marine Radio for service.

Great Barrier Island

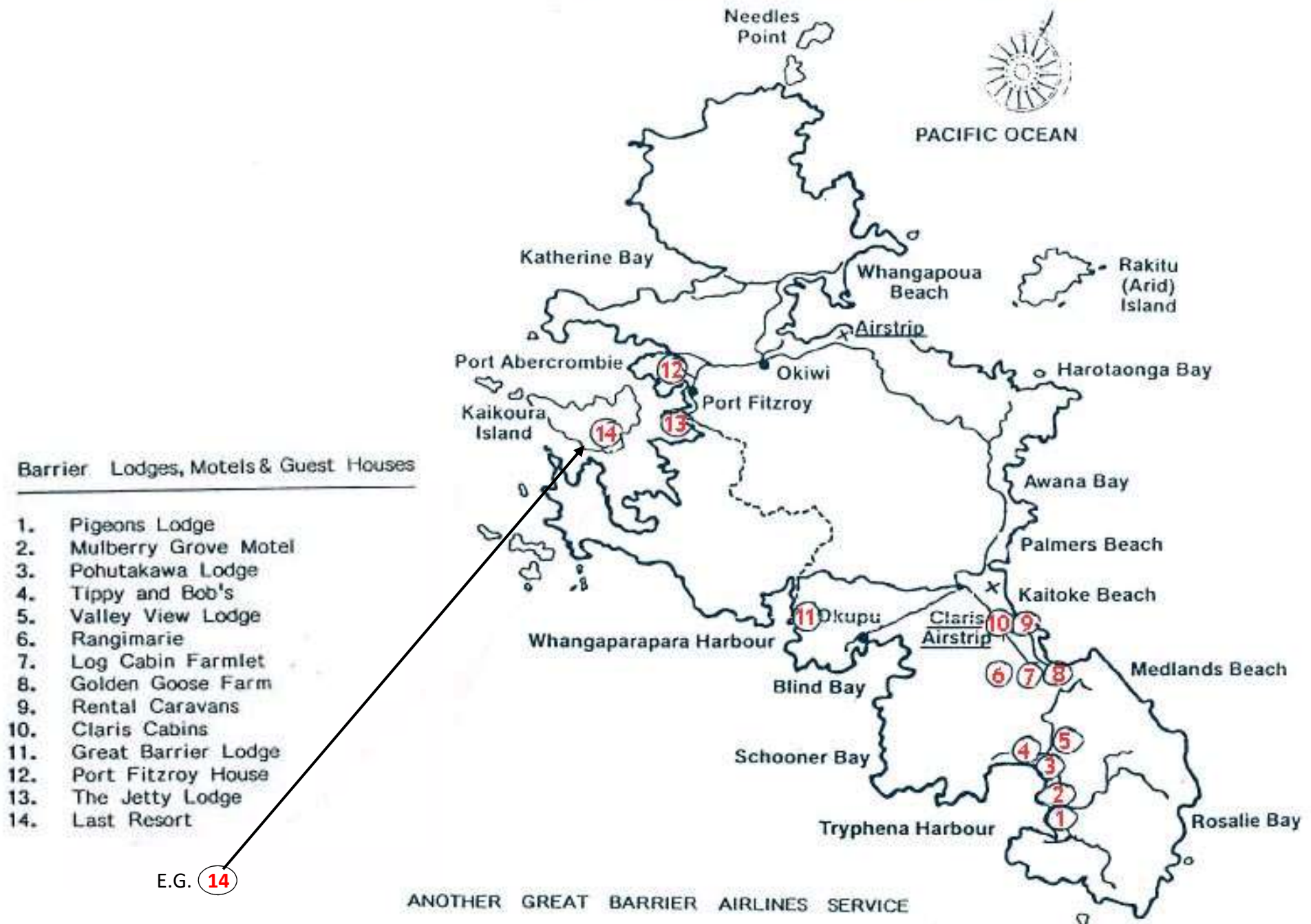

Telephone: Tryphena
Great Barrier Island
8A TRYPHENA

Proprietors: Jan & Dennis Stanley

Accommodation: 2 Chalets with private
facilities.

Lodge: 4 rooms
Each room has one double
and one single bed.

Costs: Around \$72.00 per adult.
All meals.

N.B. Meet and Greet Guests
Horses for Hire

Set overlooking Tryphena
Harbour

2 fishing dinghys and
boat with outboard,
water skiing, fishing
or diving, skippered
runabout.

Dining Good meals, 3 courses

Will organise scuba tank refills, hire
of motor bikes, rental cars.

Good value specialises in seafood meals.
Will take agent's voucher,
10% commission.

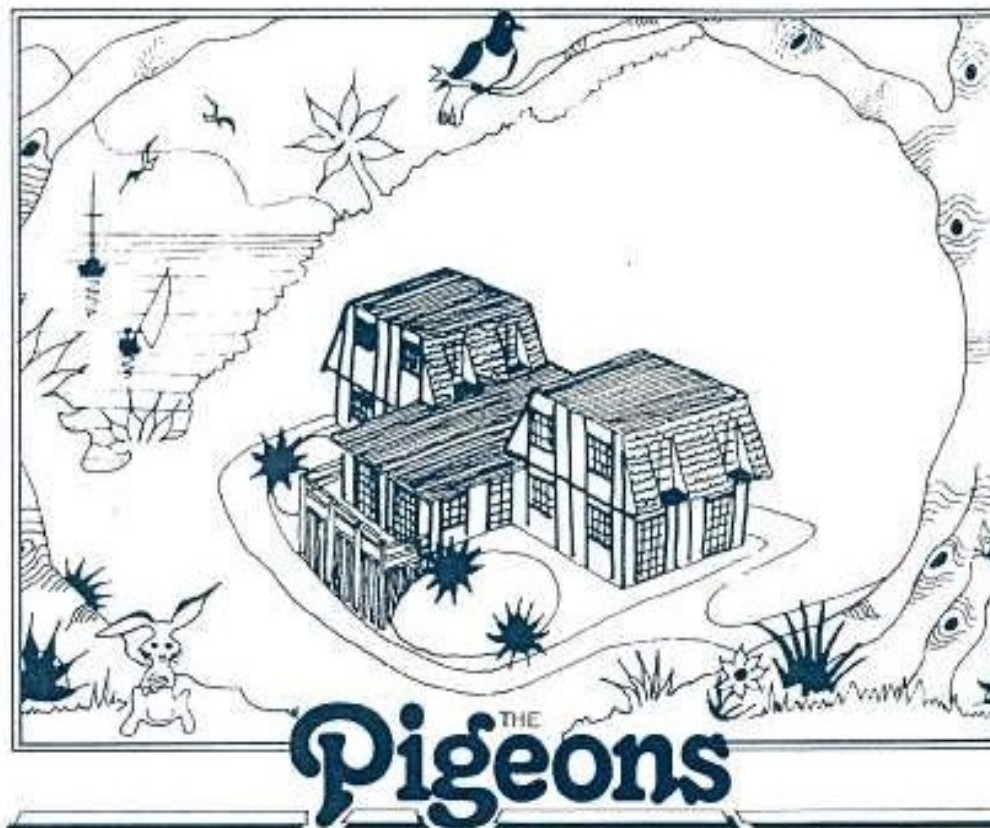

LODGE

SHOAL BAY, TRYPHENA GREAT BARRIER ISLAND

See nature at its best. Away from the rush and bustle
of city traffic.

On the foreshore of Tryphena Harbour between the
wharf and the Post Office Store, between road and
harbour. The Pigeons occupies 2 ½ acres of bush-
clad grandeur. Pigeons, Tuis and Fantails can be seen
closely without leaving the house. There are views
across the harbour and interesting walks in its own
grounds, to the jetty and lookout points. A very
spacious lounge and dining area open to a sun deck
almost suspended in the bush

With full bar facilities.

The growth of the tourist business at Great Barrier
is in its infancy. The natural attractions are superb
and visitors find more to do and see than can be
managed in the usual 4 or 5 day visit. Local tours
have recently been firmly established; launch
charters for fishing and sightseeing, motorbikes and
car hire, fishing from the wharf of "The Pigeons"
own dinghies and small sail boats are available free
to guests. Horses can be hired either for conducted
tours of "lone rider" expeditions.

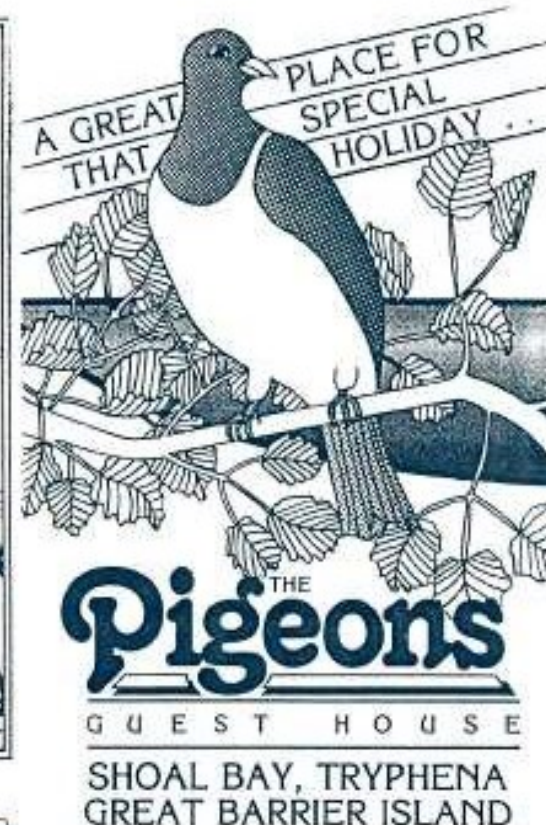

Let us look after you at "The Pigeons". Our
guesthouse lies surrounded by its own bush setting
right on the waterfront. Relax and enjoy good food
and comfortable accommodation. Laze on the beach
or swim or dive. Beautiful bush walks, sailing and
rowing dinghies and fishing gear are available free.
Relax at night; have a game of pool.

All meals are included and there is a separate TV
lounge.

The island offers magnificent bush and scenic
attractions, miles of surf beaches and safe swimming
beaches, tramping and climbing, hot springs and the
best of fishing and diving Or come to the island
during winter when it's wild and wonderful if you
dare. You could be lucky and be marooned
indefinitely.

By the way, we meet our guests at the plane on
arrival and return them to the plane on their
departure.

GREAT BARRIER ISLAND HIDEAWAY



If you wish you can prepare your own meals or dine with your fellow guests in the fire-side comfort of the main lodge. Your favourite drinks and choice of select wines are available as are billiard, television and video facilities.

The Jetty is the perfect location for honeymooners, small conferences or a quiet holiday away from it all.



Stay in fully self-contained, beautifully appointed chalets. All featuring panoramic views of the natural untouched beauty of Kaiarara Bay.



Master Booking Agent: NZ ADVENTURE CENTRE LTD Victoria Park Market.
Ph: 399-192 - A/Hrs Ph: 789-817 P O Box 72068 Aucjland 9 Telex NZ 63091

THE



Port Fitzroy

Newest accommodation on Great Barrier.
Will accept vouchers, normal 10% commission.

NICE LODGE

One Unit sleeps 4-5 ... \$130.00 per night
Chalets

Sleep 2 persons ... \$110.00 per night

All Meals and G.S.T. are extra

MULBERRY GROVE MOTEL

Telephone: Tryphena
16
Great Barrier Island

Proprietors: Gladys & Ivan Miller

Accommodation: 5 fully equipped 'A'
frame motels
Sleep up to 5 per unit, gas
stoves, fridges, shower.
Plus 2 bedsitters

Rates: \$80.00 per 'A' frame whether
1 or 4 people till end of
January 1987.

From Feb. '87: Then \$45.00 for 2 people
\$6.00 each additional person.

Bedsitter: \$45.00 per couple
+ G.S.T. all year round.

Fishing Dinghy

Travel Agent Voucher + commission 10%

Rates do not include G.S.T.

Next door to Mulberry Grove Store

BEACHFRONT

Mulberry Grove is situated on the
beachfront overlooking a beautiful
harbour. An ideal, relaxing holiday.

Fishing, swimming, hiking, or sitting
and relaxing in the garden looking
out over the harbour.

BUSH WALKS

To Hot Pools, Kauri Dams, Silver Mines, Old
Whaling Station site. Dinghies available.

LAND ROVER TOURS

Land Rover Tours and Fishing
trips available by arrangement.

HOW TO GET THERE

FLY

Great Barrier Airlines

Your hosts

Gladys & Ivan Miller

GREAT BARRIER ISLAND



Auckland's largest off-shore
Island 25 minutes from the city.

Phone Tryphena 16
Postal address, Tryphena Post Office
Great Barrier Island.

Great Barrier Is. MULBERRY GROVE MOTEL



Telephone: Tryphena
2 0
Great Barrier Island

Proprietors: Richard & Frances Greaves

Accommodation: Full Board
or casual bunk house
Cabins

Full Board \$55.00

High Season: Cabins \$13.50

Use of communal facilities

Casual meals available

Don't share rooms, only with people
they come with.

ALSO

AOTEA MOTOR BIKE RENTALS

\$36.00 day, daylight hours

ACCOMMODATION

.. Separate bedrooms sleeping from 2—5 people.

.. for the hikers passing through, sleeping bags
are welcome. Linen and blankets can be
provided for a small charge if preferred.

.. Communal, fully equipped kitchen, with
wood-range and gas cooker. Dining-room and
lounge/reading-room.

.. Hot showers.

.. Dinghy and fishing tackle provided.

.. Set in attractive surroundings 20 metres from
safe sandy beach.

.. Well-stocked shop on the premises, for your
convenience.

.. The Producers of Great Barrier Honey.

.. Relax and enjoy ice cream and teas in our tea
garden.



A pleasant, friendly place to stay or stop overnight.

ENQUIRIES: RICHARD & FRANCES GREAVES,
C/- POST OFFICE, TRYPHENA,
GREAT BARRIER ISLAND

PH 20

WILL ACCEPT TRAVEL AGENT'S VOUCHERS.



Visiting Great Barrier Island?

POHUTUKAWA LODGE

PAH BEACH
TRYPHENA HARBOUR



VISIT BARRIER'S LOVELIEST
BEACHES AND SAMPLE SOME OF
ITS MANY ATTRACTIONS



But then, we're offering you an informal and relaxed atmosphere of a true blue Lodge. Where you don't have to dress for dinner and the only rules are those you'd set for your own home.

If sitting on the upwards end of a busy fishing line is for you, we'll put free fishing tackle in your hands and put you down where the fish are known to be hungry. Or take a dinghy with our compliments and try your luck around the Bay.

If you're a serious scuba enthusiast you're amongst buddies at the Barrier Lodge. Trained and experienced, we know the seabed like our kitchen table . . . and at day's end your dive bag will provide trophies for the same kitchen table. Bottle-fills and diving tender service is all here, tanks and weight belts available.

Into the outdoors? Well your only problem is deciding where to begin. Great Barrier Island is a trampers delight. Bush walks, forest trails, high country, spectacular coastlines, natural hot springs. And native birds like you wouldn't believe - so if birdwatching is your repertoire bring your best watching and camera gear. You're not going to be disappointed. The Natural Forest Park ranger service, with tracks and planned walks is only 10 minutes from the Lodge.

No transistors, hooligans, or fizzboats. Just that good old fashioned peace and quiet. There's a dictionary full of great Picnic spots, we can arrange for Hired transport and we'll set you up with a special picnic lunch from our own kitchen.

Your base, with all the amenities set in native trees, right on the shore of the sheltered Whangaparapara Bay. Here's where you can relax over some mighty good cooking, wrap yourself in the view, shoot a little pool or billiards, turn to music, TV, darts, reading, or doing sweet nothing.



Dress, or the lack of it is very optional on Great Barrier and since you'll be coming by air service it pays to be reasonably compact. Apart from the obvious essentials, also pack stout walking shoes, sneakers, slacks or jeans, and a warm sweater (for evening barbecues), shorts, hat.

It's also wise to pack your favourite anti-sunburn lotion and insect repellent, if you're an outdoors enthusiast. (There are no poisonous or savage forms of wildlife on the Barrier, but at some times mosquitoes can get a touch personal).

Most everybody comes by one of the three main

Great Barrier Airlines Ltd
Telephone 275-9120 A/H 779-384
P.O. Box 53-073 Auckland Airport
THE BARRIER ISLAND CONNECTION



Travel Agent's Vouchers, 10% commission.

erson, fully catered. i.e. 3 course meals etc.



GREAT BARRIER ISLAND

Tipi and Bob's HOLIDAY LODGE TRYPHENA

Tryphena Harbour is situated at the Southern end of Great Barrier Island and faces the Coromandel Ranges.

A feature of this extremely beautiful harbour is the crystal clear water which allows the bottom to be seen from a depth of twenty feet or more.

From the barge ramp at Puriri Bay, the entire harbour is skirted by a scenic road which provides a pleasant four-and-a-half mile walk or dive and ends at the wharf at Shoal Bay.

Glorious white sandy beaches, shaded by Pohutukawas are to be found at the head of the bay, which are ideal for picnicking and swimming and are safe for small children.

Tryphena can be used as a base for many scenic, picnic, swimming and tramping activities.

For instance the old gold and silver mines at Whangaparapara are well worth a visit as are the hot pools which are reached by an interesting bush walk.

Rock hounds will be well satisfied with a sortie to Okupu and the East Coast usually provides good surfing for the more active swimmer.

Tipi and Bob's Holiday Lodge is situated on the water's edge of Tryphena Harbour, from which a magnificent panorama of this boaties' haven is gained, and it is not uncommon to see Dolphins at play from the lounge windows.

Each guest room opens onto the sun deck where the paper may be read or mail written, if you can tear your eyes away from the unsurpassed beauty of this holiday spot.

There is also a self-contained cottage which is let daily or weekly.

Bob is a professional fisherman who knows where the big ones are to be caught, so if fishing is your forte the launch is sometimes available when Bob is not at sea. Dinghy and outboard are also available.

With excellent food, a real family atmosphere and a soft comfortable bed to retire to at the end of an enjoyable day - what more could anyone want?

For bookings and enquiries: PHONE TRYPHENA 5A

LODGE:

\$55.00 per person, all meals. Sleeps 4
in the house overlooking Tryphena Harbour.

COTTAGE:

Sleeps 4, self contained at \$55 per couple.
Extra person \$5.00 per head.

- All prices inclusive of G.S.T.
- Meals can be arranged for the cottage.
- Will accept agent's vouchers, normal commission.
- Dinghys with outboard available.

FITZROY HOUSE - On harbour foreshore

PH: 2 Port Fitzroy

- Rooms with private facilities.
- Self contained unit. Optional meals.
- Family room available.
- Maximum group booking twenty persons
- All inclusive tariff and G.S.T. is \$71.50 per person.
- Self contained unit is \$55.00 (G.S.T. included). From 1 to 6 people per day
- Meet and greet G.B.A.
- Travel vouchers, normal 10%.
- Fishing tackle and dinghy supplied, outboard available.

VERY NICE!

For your best holiday ever, stay at
POHUTUKAWA LODGE

A home away from home. Pa Beach in the Tryphena Harbour, in a lovely garden setting, 50 metres from safe sandy beach. Your own bunk room with comfortable beds. Occupants bring sleeping bags and pillow slips, or linen and blankets can be hired. Fully equipped share kitchen, all gas cookers, share dining room and comfortable lounge/reading room. Hot showers and outside 'flush' loo. Tariff for 1986-87 \$13 per night, with special concessions for families and reduced rates during off season.

ALTERNATIVELY full board is catered for in main homestead, all wholesome home cooked meals, colour T.V./music room, open fire in winter, plus bathroom and toilet shared between two rooms. Tariff 1986-87 \$55 per day, with off season rates. These rooms are also available to those who prefer more privacy, yet wish to have full use of communal kitchen for the preparation of their own meals.

Phone Tryphena 20

Have you stayed at
TIPI AND BOBS?
 Why Not?

Right by the water, close to shops.
 Friendly atmosphere, and food is tops.
 Phone 5A Tryphena

LOG CABIN FARMLET

KAITOKÉ

Self contained plus casual private accommodation

Wholefood meals on request.

Peaceful Christian environment.

Phone: Claris 2M

Your Hostess: Caroline de Latour

VALLEY VIEW LODGE

- In valley close to Tryphena Harbour
- Hosts Elaine and Chris
- Phone Tryphena 6D

**PALMERS BEACH
 FARM GUEST HOUSE**

A beach front surrounded by picturesque farmland.

Home cooked meals in a relaxed atmosphere.

Courtesy car service to and from Claris Aerodrome.

For brochure and tariff, write:

JOHN AND SHIRLEY GRAY

Claris P.O.

Great Barrier Island.

Phone Claris 1D

**RANGIMARIE
 FARMLET**

5 minutes walk from beautiful Medlands Beach. For those on a limited budget, Rangimarie offers excellent value for money with 4 rooms that share an equipped kitchen and lounge. Lighting is reliably provided by a wind generator.

Organically grown fruit, vegetables, milk and eggs are available for purchase and used to provide wholesome meals when required. The nearest shop and airport are 40 minutes walk away. Taxi and Island tours collect and return to our gate.

YOUR HOSTS

Tim and Robyn Roberts

c/- P.O. Claris

Phone 6M

GOLDEN GOOSE LODGE

Exclusive accommodation.
Situated in the lovely Medlands Valley.
Fabulous surf beach.
Courtesy car to airfield, golf course and hot springs.
Tours, rental car arranged.

Phone Claris 6U or write
c/- Claris P.O.
Great Barrier Island

Proprietors: O'Tooles
Accommodation: 2 rooms -
2 with double and
1 single
1 with 2 single
beds

T V

Stereo

Swimming pool

Reasonable rates - Good meals

Will meet and greet passengers

At Claris Airport.

Around \$50.00 + G.S.T., all meals, per person.

Will take Travel Vouchers, 10% commission.

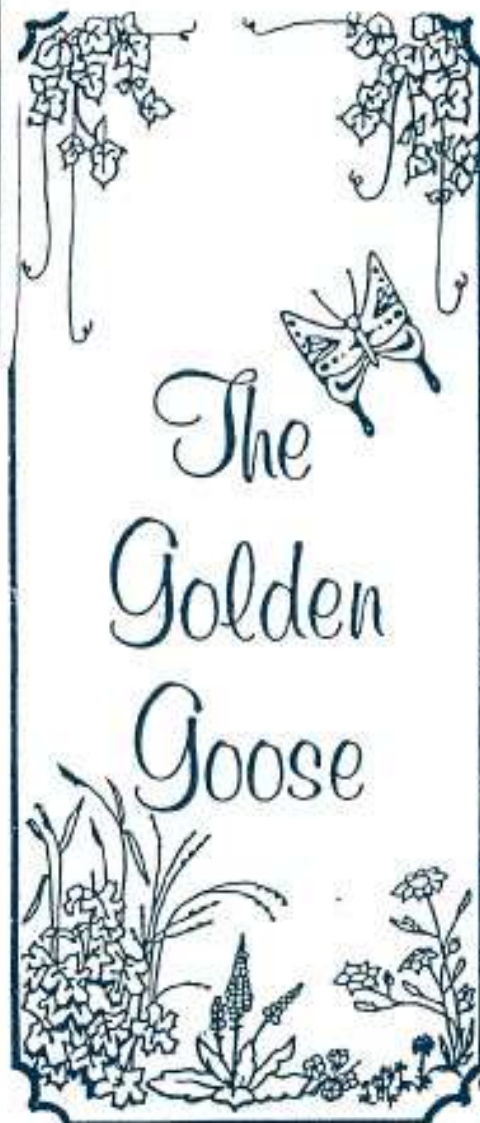

The Golden Goose

Great Barrier Island

50 miles off the coast of Auckland,
Unspoilt by commercialism and sophistication

Our special place on Great Barrier rests against the backdrop of a beautiful mountain and tranquil bush clad foothills. The west coast of the island boasts lovely harbours and the east its fertile valleys which slope down to where the blue Pacific rolls onto the shores of dazzling white sweeps of beaches.

There are tracks through the bush for those who love tramping; swimming - your choice of sea or pool; and, if the weather is good, you might like to try your hand at fishing. And, of course, there is nothing to stop you from spending your time just relaxing amid such glorious scenery and peaceful surroundings.

If this sounds like the kind of holiday you've been looking for, why not book in now at our Medlands Beach farm? We'll take good care of you. Full accommodation includes:-

cosy rooms swimming pool
lounge and
colour T.V. tasty meals

Tariff-----per day..

Transport available through:

Ring Claris 6U or write:-
O'Tooles, The Golden Goose
Great Barrier Island
Transport available through:

GBA Great Barrier Airlines Ltd
Telephone 275-9120 A/H 779-384
P.O. Box 53-073 Auckland Airport
THE BARRIER ISLAND CONNECTION



PRICES FROM:

\$60 day per person

All meals

G.S.T. included

Travel voucher, normal commission

Specialise in serving crayfish

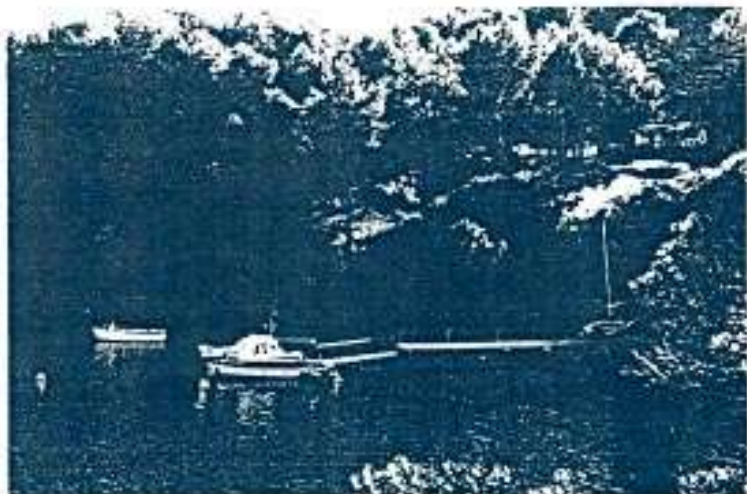

The Lost Resort is situated on the leeward side of Kaikoura Island at the entrance to picturesque Port Fitzroy Harbour on Great Barrier Island.

Although only about 80km separate the island from the mainland, this isolation has made it unique. The whole atmosphere is very relaxed and friendly and the scenery is magnificent.

There are many things to do and see at Kaikoura and Gt Barrier Islands. The waters are filled with many different species of fish including crayfish. The abundance of fish together with its clear water and many small islands make it a paradise for snorkelling and skin diving.

Kaikoura and Gt Barrier Islands are excellent for tramping.

The Lost Resort is ideally suited for groups up to 30 - schools, clubs, firms, charter boat groups, etc. Special rates apply for block bookings.

The main building at the Lost Resort houses the kitchen, dining room, (seating for 40), lounge (TV and open fireplace), ames room and bar (with pool table). There are 12 double cabins amongst the trees. Another building houses the toilets, showers and washing facilities.

Three meals a day are included in the tariff, including the finest seafood dishes.

FACILITIES AVAILABLE

Diving gear, fishing gear, dive compressor, small catamaran, water scooter (2 man), smoke-house etc.

We can arrange: Island tours, GT Barrier safari tours, boat trips around the islands. We are associated with some of the top charter boats providing the best diving and fishing (line or big game).

LOG CABIN FARM

Telephone: Claris
2 M
Great Barrier Island

Proprietor: Caroline de Latour

- * Will pick up and drop off
- * O.K. for families
- * Rustic Garden Cottage
- * Main Guest Unit
- * Lovely views - bush/seas/rural
100 acres of privacy
- * Meals - Optional
- * No Refrigerator



LOG CABIN is like home away from home away from home i.e. Tea, Coffee, Breakfast supplies provided.

Around \$50.00 + G.S.T., main Guest Unit or Garden Cottage.

No Travel Vouchers.

VERY NICE!

BARRIER RENTAL CARAVANS

RENTAL CARAVANS

Kaitoke Beach - Claris - Great Barrier Island

Winnie or Charlie Ph: 6G Claris

or Great Barrier Airlines 25S Claris Airport
275-6612 or 275-9120 Auckland. A/H 779-384 (24Hrs)



A GREAT INDOORS FOR A GREAT OUTDOORS



A G.B.A. Airporter Bus

FLY TO THE
ISLAND WITH
GREAT
BARRIER
AIRLINES
275-6612 Auck.
275-9120
A/H 779-384 (24hrs)

Fully serviced rental caravans with awnings situated in sheltered attractive bush area 1 min from Kaitoke beach and Sugar Loaf beautiful sheltered beach and rock sheltered swimming area. Free gas and fresh water delivered daily, chemical toilet supplied, 20 mins walk to Claris Airfield, store and garage. Complete Fly-Rent a Caravan deals available for one or more nights with free G.B.A. Airporter transfer to and from your caravan. Everything supplied except bedding, we suggest sleeping bags. Bring towels, food and a torch or two.

Holiday, summer and off-season rates for information contract G.B.A. or on the Island Winnie or Charlie.



Another Great Barrier Airlines Service

Great Barrier Forest

Situated in the central massif area of the island, Great Barrier Forest has a total area of 7,900 ha.

The topography is steep, rugged and very much dissected by streams. Mt Hiramata (Hobson) 621m, (2,038ft) is the principal point from which the main streams originate.

These are the Kaiarara, Awaana and Kaitoke. Other streams (Kiwiriki, Coffins and Wairahi) originate from the chain of rhyolitic ridges that extend south of Mt Hobson.

Prior to the Forest Service Administration, the entire forest had been logged for kauri, portions dug over for kauri gum, and the Whitecliffs area mined for gold and silver.

The first trees were felled in 1794 when the British Navy removed kauri from the Kaiarara for spars.

The total quantity of kauri taken out from Great Barrier Island is estimated to have exceeded 100 million feet log measure.

Fires have added to the destruction of bush areas. In 1887 a fire starting in the Kaitoke region swept north through the

Fires have added to the destruction of bush areas. In 1887 a fire starting in the Kaitoke region swept north through the headwater of the Awana Stream and burned for three months. In 1911 a large fire ran riot on the southern slopes of the Upper Kaiarara Basin. The only introduced animals in the forest were goats, pigs and rabbits. Captain Cook liberated the first goats on the northern tip of the island.

Today the forest is a Kauri Management /Research unit with areas set aside for sanctuaries and recreation. Improvements by releasing from nurse crop T. tree of naturally regenerating kauri stands is supplemented by an annual planting of 5,000 kauri seedlings in areas devoid of regeneration.

Trampers huts at the Kaiarara Creek and Whangaparapara cater for a variety of visitors, school children and youth groups. Maintaining the 121 kilometres of walking tracks which cross the rough terrain is a continuous job.

Pools have been formed and toilets installed at the Kaitoke Hot Springs and the 'Green' camp mine site at Whangaparapara. The NZFS launch "Aotea" maintains a fire-information-assistance patrol during the summer (fire) season to the every increasing boating fraternity.

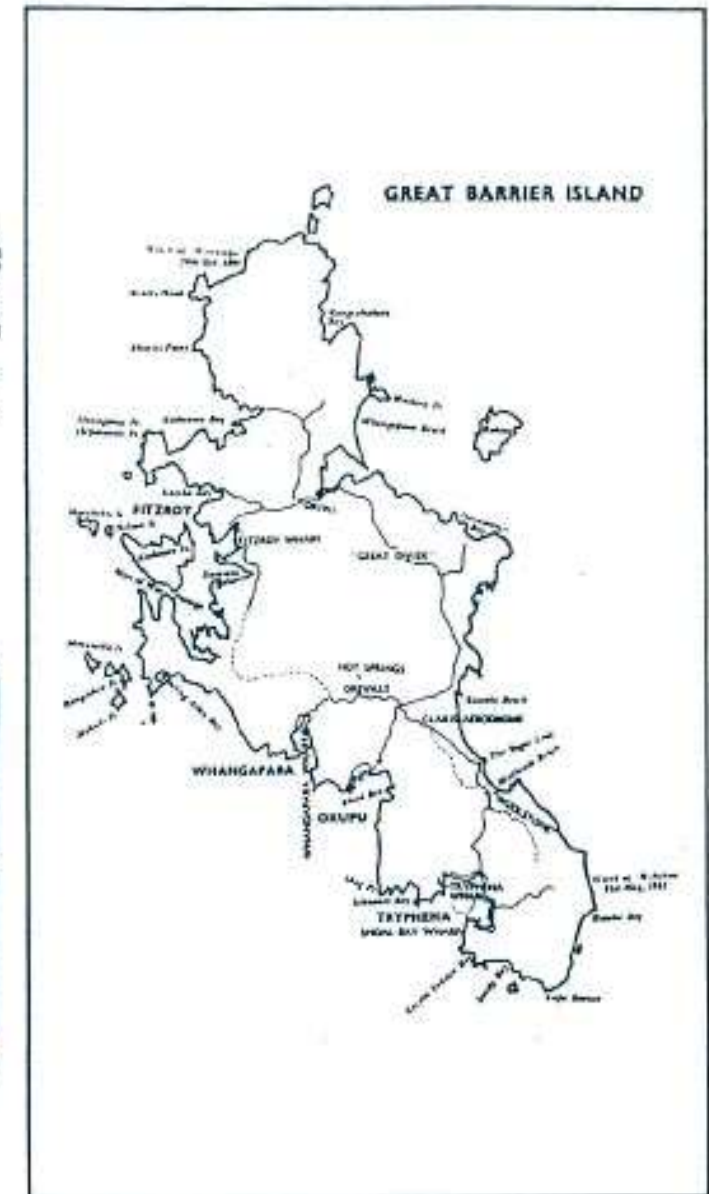

ENJOY YOUR FOREST,
BE CAREFUL WITH FIRE.

MULBERRY GROVE STORE

PH: 20 Tryphena or CH 2 on CB

- Rental cars \$50.00 per day all inclusive
 - Scuba tank refills
 - Taxi service
 - General store
 - Wines and Spirits
 - G.B.A. airline transfer and ticket agent
 - Fuel, L.P.G., Gas refill
-

CLARIS STORE

- Fresh fruit, veges and meat
- G.B.A. ticket agent
- Camping and fishing gear

Operate a mobile shop to the
camping areas of Medlands and
Awawa during the summer.

Phone: 17R Claris

SHOAL BAY STORE

Through the cutting
from the Wharf.



Bob and Sally
Phone 17, Tryphena

Step ashore
at
Shoal Bay Store!

STONE WALL STORE

Pa Beach, Tryphena

Phone Tryphena 20

For quick and friendly service at our owner
operated store.

Competitively priced grocery lines, fresh bread,
meat, fruit and vegetables.

Cone ice cream our speciality.

Gifts for everyone and a wide range of souvenirs,
including T shirts.

Tea and coffee garden with light refreshments, hot
pies and cakes.

SHOPS

MULBERRY GROVE STORE and POST OFFICE, Mulberry Grove, Tryphena Harbour.
Ph Tryphena 20

STONEWALL STORE - Pah Beach, Tryphena Harbour. Ph Tryphena 20

CLARIS STORE - Claris Main Rd. Ph Claris 17R

GREAT BARRIER LODGE STORE - Whangaparapara Harbour. Ph Claris 4H

PORT FITZROY STORE and POST OFFICE - Port Fitzroy Harbour. Ph Port Fitzroy 8

ANOTHER GREAT BARRIER AIRLINES SERVICE

N.Z. ADVENTURE CENTRE LTD

GREAT BARRIER ISLAND HOLIDAY ITINERARIES

INDIVIDUAL ALL INCLUSIVE: AIR DEPARTURES FROM AUCKLAND DEC 16TH 1986 TO DEC 15TH 1987.
PRICES IN N.Z. DOLLARS & INCLUDE GOVT. GST TAX.

1 DAY. Holiday No: GB1-L

1 Day Island Safari.

Morning flight to Great Barrier. Met on arrival by Martin Gillard and his safari bus for sightseeing tour of this beautiful island. See the magnificent East Coast beaches, Whangaparapara Bay (Site of an old whaling station) and Southern Tryphena.

Includes excellent lunch. Return late afternoon by air to Auckland. Price per person includes return flight, Safari Tour, morning tea, lunch & Island transfers. Dec 16 1986 to April 30 1987 \$249 per person. May to Dec 15 1987 \$225 per person. Single supplement \$30

3 DAYS Holiday No: GB2

Weekends Fri-Sun or any 3 day period

Day 1: Morning departure (or PM) by air to location of your choice. Met on arrival and transferred to your lodge accommodation. Afternoon free.

Day 2: "Do your own thing." Free for bush walks, swimming, fishing or just relax in beautiful surroundings. Optional local tours available.

Day 3: Morning free for your own pursuits. This afternoon we transfer you to your return flight to Auckland.

SELECT YOUR ACCOMMODATIONS: Prices include: Twin, double or single rooms, all meals, return flights, Island transfers, and Government GST tax.

PIGEONS LODGE: Southern Tryphena. Set amidst beautiful native bush. Small lodge one bathroom between two bed rooms. Two units with private facilities. Dec 16 '86 - April 30 '87 \$319 per person. May 1st to Dec 15 1987 \$287 per person.

GREAT BARRIER LODGE: West Coast Whangaparapara. Waterfront location in sheltered cove. Share bathrooms, all meals included.

Dec 16 1986 to April 30 1987 \$329 per person. May 1 to Dec 15 1987 \$297 per person.

Northern Fitzroy LOST RESORT LODGE: A separate Island forming part of the beautiful Fitzroy harbour. Clean and comfortable cabins with share facilities. Good restaurant. All meals basis.

Dec 16 1986 to April 30 1987 \$295 per person.

May 1 1987 to Dec 16 1987 \$265 per person.

THE JETTY: New luxurious chalets with private facilities. Waterfront outlook in beautiful bay. All meals basis: Dec 16 1986 to April 30 1987 \$387 per person May 1 to Dec 15 1987 \$349 per person.

NOTE: All lodges will supply take-away picnic lunches if you wish to spend the day away on walks etc. - Holiday weekend prices are as shown for summer period.

5 DAYS Holiday No: GB3

West Coast Whangaparapara and Northern Fitzroy. Departs every Tuesday Dec 16 1986 to April 28 1987 and every second Sunday from May 3 1987 to Dec 13 1987

DAY 1 (Tue or Sun) Depart by air from Auckland.

On arrival met and transferred Lodge, on the waterfront. (Share facilities). Excellent for relaxation, boating etc.

DAY 2 (Wed or Mon) At Whangaparapara (Barrier Lodge). Time is yours to follow your own activities or relax. The natural hot springs are great in winter!

DAY 3 (Thurs or Tue) This morning we take a picnic lunch and depart on our safari tour via the East Coast beaches and mountainous interior to Port Fitzroy. Early afternoon arrive at the treelined harbour of Port Fitzroy. A choice of two accommodations here. "The Lost Resort" or the "Jetty" (see holiday prices).

DAY 4 (Fri or Wed) At Port Fitzroy, Do your own thing. The old kauri dams are a popular day's walk. (Your lodge will provide a picnic lunch.)

DAY 5 (Sat or Thurs) Morning free. This afternoon we transfer you to your flight for return to the "city life". Prices per person with Fitzroy accommodation of your choice:

	The Lost Resort (share facilities)	The Jetty (private facilities)
Dec 16 '86' to April 28 '87'	\$499	\$599
May 3 to Dec 13 '87	\$445	\$525
Single supplement	\$ 35	\$ 35

Prices include flights as detailed, accommodation, all meals, safari tour, Island transfers and Government GST tax.

7 DAYS Holiday No: GB4

BARRIER DISCOVERER

Departs every Sunday from Jan 4 1987 to Sunday April 26 1987 and every second Friday from May 1 to Dec 11 1987.

DAY 1 (Sun or Fri) This morning's flight takes you to another world! Met on arrival and transferred to your lodge accommodation. Afternoon at leisure.

DAY 2 (Mon or Sat) Free for your own pursuits. Staying at Pigeons Lodge or similar, Tryphena.

DAY 3 (Tue or Sun) Morning Safari Tour terminating at the West Coast inlet of Whangaparapara. Stay at the Great Barrier Lodge. Many bush walks (hot natural springs) and boating available here.

DAY 4 (Wed and Mon) At leisure to follow your own activities. (Free use of dinghies and fishing gear at all our Barrier Lodges, but take your favourite fishing rod!)

DAY 5 (Thur or Tue) We pack a picnic lunch today and take you on another Safari Tour via the East Coast beaches and mountainous interior to Port Fitzroy and your cabin or Chalet accommodation.

DAY 6 (Fri or Wed) At Fitzroy Harbour. Kauri dam walks, boating, fishing, swimming or relaxing.

DAY 7 (Sat or Thur) At leisure until this afternoon when you must depart your Island for the return flight to Auckland.

PRICE PER PERSON with Fitzroy accommodation of your choice:

	The Lost Resort (share facilities)	The Jetty (private facilities)
Jan 4 to April 26 '87'	\$697	\$797
May 1 to Dec 11 '87	\$599	\$699
Single supplement	\$ 65	\$ 65

PRICE INCLUDES return flights, accommodation, all meals, safari tours, Island transfers and Government GST tax.

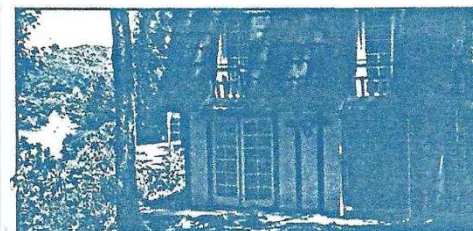

Pigeons Lodge Tryphena



The Lost Resort, Port Fitzroy



Individual private facility units at the Jetty Lodge

CRUISES

Cruise the Gulf on the historic 86ft. schooner "Te Aroha". 4, 3 day and weekend cruises. Comfortable 2 person cabin accommodation. Ask for brochure. Ask about our other Gulf cruises, Harbour cruises and ship/launch/yacht charters.

PLEASE NOTE: Extra days can be added prior to or after all Holidays.

FOR BOOKINGS CONTACT

"The New Zealand holiday and cruise people"

AT VICTORIA PARK MARKET, AUCKLAND. PHONE 399-192. A/H: 489-817.

N.Z. Adventure Centre Ltd operators of Great Barrier Island holidays reserves the right to amend itineraries if circumstances dictate. Prices are subject to change without notice. Conditions of travel will be presented prior to departure. Cancellation charges will apply if arrangements are cancelled after reservations made. A deposit of \$75 per person payable prior to reservations being confirmed. Balance payable 3 weeks prior to departure. We regret the operators are not responsible for weather conditions. Part or full payment of fare signifies acceptance of price.

Your Local Booking Agent:

AUCKLAND. PHONE 399-192.

A/H: 489-817.

SAFARI TRAVEL CENTRE



CAN ARRANGE:

Travel to and from the Island — Air or Sea

Accommodation	Tours
Launch Trips	Dive Trips
Fishing Trips	Horse Riding

SEE SAFARI TRAVEL INFORMATION
BOARDS FOR DETAILS

To book on the Island either:

Ask your host to contact us
or Phone us at Tryphena 22H

or for boats — call "Safari Tours"
on your C.B. Channel 2

If off the Island write to:

SAFARI TRAVEL CENTRE

c/- P.O. Tryphena

Great Barrier Island

"We will gladly assist you"



ISLAND TRANSPORT

"AIRPORTER" Free minibus transfer services
to/from Airfields to Tryphena-Whangaparapara
-Port Fitzroy, Lodges, guest houses and motels
for Great Barrier Airlines passengers.

TAXIS Mulberry Grove Taxis Ph Tryphena 20
Clariss Taxis Ph Clariss 17S

TOURS Safari Tours Ph Tryphena 22H
Scenic Tours Ph Clariss 17S
Aotea Tours Ph P.Fitzroy 2

RENTAL CARS Mulberry Grove Station
Ph Tryphena 20
Clariss Garage
Ph Clariss 17S

RENTAL MOTOR CYCLES Stonewall Store
Ph Clariss 20



CLARIS TAXI SERVICE

Phone 1S or 17S Clariss

For passenger transport all over Great Barrier.

Cars available for hire or general taxi work.

Rental Car from \$50/Day,
all insurance, etc.

ISLAND FLIGHT SEEING - SKY TOUR



Ph Clariss 25S
Auckland
275-6612, 275-9120

GREAT BARRIER AIRLINES Clariss Airfield

GOLF

18 hole course Clariss Ph: 21S

GARAGES

Mulberry Grove Garage Ph Tryphena 20
Clariss Garage Ph Clariss 17S

CLARIS MOTORS

GREAT BARRIER ISLAND

Phone 17S Clariss

Members of the Motor Trade Assn.

Suppliers of Mobil fuels and Lube oils.
Agents for Rock gas, L.P.G.

GREAT BARRIER ISLAND SCENIC TOURS

Phone 1S or 17S Clariss

Bus tours to visit Great Barrier's scenic
and historic places of interest.

Buses pick up and deliver to Guest
Houses, Clariss Air Field, and
Whangaparapara Wharf.

Discounts for Groups, Clubs and
School Parties.



Great Barrier Charters Ltd M.V. Greta

Great Barrier Charters Ltd is based in picturesque Port Fitzroy on Great Barrier Island. Thirty minutes by plane from Auckland and you are amongst some of New Zealand's finest diving and fishing. Hugh Golaboski, owner/skipper/diver has many years experience diving and fishing in the waters of the Barrier. Arrange your own accommodation or let us do it for you. Our services are available daily from Port Fitzroy and include:

- **Dive Trips** — An excellent variety of diving available. We have a full range of hire gear available including tanks and weight belts to save on excess baggage on your flight over.
- **Fishing** — Snapper, big game and light tackle game. Bring your own gear or we can supply it.
- **Dive Guide** — If you have your own boat but don't know the spots, hire a dive guide.
- **Scenic Cruises** — Half or full day charters available for parties of up to 15.
- **Small Boat Charter** — To cater for groups of up to 4 people for diving or fishing.
- **Water Taxi** — Transport to any destination requiring access by sea.

For more information please contact:

Hugh Golaboski or Judith Cowie
Great Barrier Charters Ltd
c/o The Post Office
Port Fitzroy Phone 1R
Great Barrier Island



BOAT TRIPS - DIVING ETC.



AOTEA CHARTER Ph Tryphena 18K
GREAT BARRIER CHARTERS Ph P.Fitzroy 1R

GULF RUNNER CHARTERS

43 foot motor launch operating from Auckland and Great Barrier.
For diving, fishing, sightseeing.
Special Fly/Cruise G.T. Barrier Holidays Jan, Feb, March, 1985.
Please write for full details.
VAL AND STAN HONEYBUN
11 McCrystal Avenue, Bucklands Beach. Phone 534-9769

AOTEA CHARTERS

LAUNCH TRIPS ARRANGED

DIVE PARTIES WITH AIR TANKS
& WEIGHT BELTS PROVIDED

FISHING AND SIGHTSEEING WITH
TACKLE AND BAIT PROVIDED

AVAILABLE BY THE HOUR OR DAY

Phone:
AOTEA CHARTERS
Tryphena 18K

c/- P.O. Tryphena,
Gt. Barrier Island

GULF RUNNER CHARTERS

GREAT BARRIER ISLAND HOLIDAYS - JANUARY - FEBRUARY - MARCH

If you are looking for a holiday with a difference, join us for a 4-day Fly/Cruise holiday at Great Barrier.

Depart: Monday from Mangere, Auckland by Great Barrier Airlines

from Mangere - 11 am

Arrives Claris Airfield - 11.40am

You will be met at Claris for a short drive to join Gulf-Runner at Tryphena wharf. Your on-board stay lasts until Thursday morning during which time you will see most of the Barrier, and its beautiful bays from the sea - have the opportunity to fish or dive - visit the Old Copper Mine near Miners Head - visit 'Websters Wonderland' at Smokehouse Bay - the Gannet Colony and Neils Restaurant at Kaikoura Island.

On Thursday morning after breakfast, Martin Gillard of Safari Tours will collect you at Tryphena Wharf for a full day's land tour, terminating at Claris Airfield for your flight home at 4pm.

While aboard Gulf-Runner, you will have all meals supplied, pillows, bedding etc, and a complimentary drink with your evening meal.

This is not a super luxury cruise but Gulf-Runner offers many miles of sheltered waters, bays and inlets unique in New Zealand. All you need to bring is your own toiletries, clothes (bring a cardigan or something warm), swimsuits and if possible soft luggage rather than a suitcase AND ALSO A SLEEPING BAG. In the case of divers, wetsuits and tanks are supplied.

For these trips, maximum number of guests = 8
minimum number of guests = 4 (or less by arrangement)

If you wish to extend your stay at Great Barrier, we can book you at a Motel or Guest House, and you can fly home on your pre-paid ticket at your convenience.

Bookings for Cruises and extended stay essential.

Cruise Dates - From January 12, 1987

In the unlikely event of adverse weather, we will re-book or refund your deposit.

Should you wish, we will be pleased to show you over Gulf-Runner prior to your booking. Please telephone and make an appointment -

Telephone: 534.9769 Auckland.

GULF RUNNER, Val & Stan Honeybun
43' x 14' x 3'6" 25 yrs experience
MOT survey. Hauraki Gulf
Hot shower operates from
stereo etc. Auckland, Gt
Barrier Island
Sandspit



SPECIAL GT BARRIER FLY/CRUISE HOLIDAYS JAN. FEB. MARCH

Fly Gt Barrier Airlines Monday. On arrival Claris Airfield your courtesy car meets you for a short drive to board Gulf Runner at Tryphena Wharf. Cruise, fish, dive around the unique waters and inlets of the Barrier until Thursday morning when, after breakfast on board, you join Safari Tours for a full day land cruise terminating at Claris for your flight home at 4.00 pm. Full cost including flights, meals, accommodation aboard land & sea cruise

* Extended stay motel or guest house optional extra.

**BOOKINGS ESSENTIAL
FOR FULL DETAILS PLEASE CONTACT**

S. Honeybun

11 McCrystal Ave Bucklands Beach

Ph 5349769 AK

Aotea Tours

GREAT BARRIER ISLAND

Phone Port Fitzroy 2

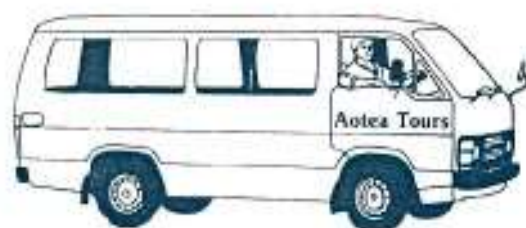

Aotea, gem of the Gulf, has many interesting aspects to explore. From bush clad hills to surf pounded shores. The Island offers spectacular scenery.

COME WITH US & SEE IT ALL

Half and Full Day Tours : Speciality Tours
Group Concessions : Flexible Timetable

OUR AIM IS TO PLEASE.

WE WILL DO ALL WE CAN TO MEET
ANY REQUIREMENTS.

See inside for details

**Tour
1**

NORTH - SOUTH TOUR

Full Day \$26.00

Departs 10am Mon, Wed, Fri. Approx 7 hours
A comprehensive tour travelling the length of Aotea. Windy Canyons, golden sand. Historic places of interest and much more, go into making this excursion the creme de la creme of sightseeing of Great Barrier. Packed lunch essential.

**Tour
2**

OKIWI SIGHT SEE

Half Day \$15.00

Departs 9am & 1.30pm Tues, Thurs, Sun. 3 1/2 hours
Transversing Okiwi Basin, North, South, East & West. Covering all points of interest to be found on the Northern Coast. Lands & Survey Station, Babaco growing and graves from N.Z. worst maritime disaster. Complementary light refreshment.

**Tour
3**

AWANA BEACH & MUSEUM

Half Day \$15.00

Departs 1.30pm Tues, Thurs, Sun. 3 1/2 hours
A chance to visit the East Coast's most popular surf beach. Swimwear essential. On the way explore the Windy Canyons and on the return journey a stop at Aotea's only museum, a treasure trove of history. Complementary light refreshment.

**Tour
4**

WHANGAPOUA BEACH

\$8.50

By arrangement only
A drop off and pick up service to the Northern end of the beach allowing you to enjoy the solitude of this magnificent 2.5km stretch of sand. Packed lunch and swimwear required.

**Tour
5**

MT HOBSON via Windy Canyons

\$5.00

By arrangement only
A drop-off service to the Windy Canyons allowing you to enjoy a unique ascent to Mt Hobson. Return to Port Fitzroy via the Kauri Dams. An all day walk. Packed lunch required.

A minimum of FOUR is required for all tours or by arrangement.

All tours depart from and return to Port Fitzroy Public Wharf or by arrangement.

All departure times are approximate and will be confirmed when booking.

Bookings can be made by phoning Port Fitzroy 2 or at the Fitzroy Guest House.

